

PARTS DETAIL :-

S No.	PART NAME	MATERIAL	QTY.
1	BODY	D.I	1
2	DISC	SS316	1
3	LINER	EPDM	1
4	STEM	AST A 276 , GR SS410	1
5	BUSH	PTFE / NYLON	3
6	O-RINGS	EPDM	2
7	NOTCH PLATE	M.S (POWDER COATING)	1
8	HANDLEVER	M.S (POWDER COATING)	1
9	FASTENER	SS / MS	3

HYDROSTATIC TEST PRESSURE

BODY (Kgfl/cm2)	SEAT (Kgfl/cm2)
37.5	27.5

SIZE	RATING	VALVE DIMENSIONS									MOUNTING FLANGE DETAIL		
		A	H1	H2	H3	L	ØD	FLANGE STANDARD	FACING	PCD-1	PCD	HOLE DIA	NO. OF HOLES
DN-40	PN25	33	57	125	28	175	40.5	IS:1538/BS:4505	RAISED FACE	126	50	7	4
DN-50	PN25	43	62	120	28	175	50.5	IS:1538/BS:4505	RAISED FACE	145	50	7	4
DN-65	PN25	46	72	130	34	216	65	IS:1538/BS:4505	RAISED FACE	160	50	7	4
DN-80	PN25	46	76	140	34	216	80	IS:1538/BS:4505	RAISED FACE	180	50	7	4
DN-100	PN25	52	95	160	39	267	100	IS:1538/BS:4505	RAISED FACE	210	50	7	4
DN-125	PN25	56	114	170	39	267	123	IS:1538/BS:4505	RAISED FACE	240	70	10	4
DN-150	PN25	56	126	190	39	267	148.5	IS:1538/BS:4505	RAISED FACE	275	70	10	4
DN-200	PN25	60	161	230	45	350	197	IS:1538/BS:4505	RAISED FACE	295	70	10	4
DN-250	PN25	68	215	280	45	350	250.5	IS:1538/BS:4505	RAISED FACE	358	70	12	4
DN-300	PN25	78	230	310	45	350	299.5	IS:1538/BS:4505	RAISED FACE	429	70	12	4

SKS
VALVES

CLIENT

P.O./ENQ. NO.

Model : SKS 118S6L

GAD No. : 19BFDT0006-03

Face to Face :

Valve Type : BFCONCENTRIC

SEAT: Hand Lever

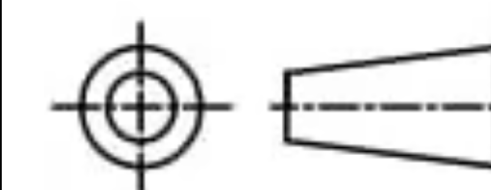

SCALE
N.T.S

SHEET 1 OF 1

Due to Continuous Development we reserve the rights to change in dimensions & Design keeping standard specification same.

All Dimensions are in MM unless otherwise stated.