

Size	D	A	B	L	L1	L2	H	H1	Weight(g)
1/2"	Ø11	G1/2	G3/4	88.3	12.5	54	32	46	142
3/4"	Ø12	G3/4	G1	96	13.5	54	32.8	48.8	211
1"	Ø13.5	G1	G1 1/4	106.5	16	69	38.5	61.4	310

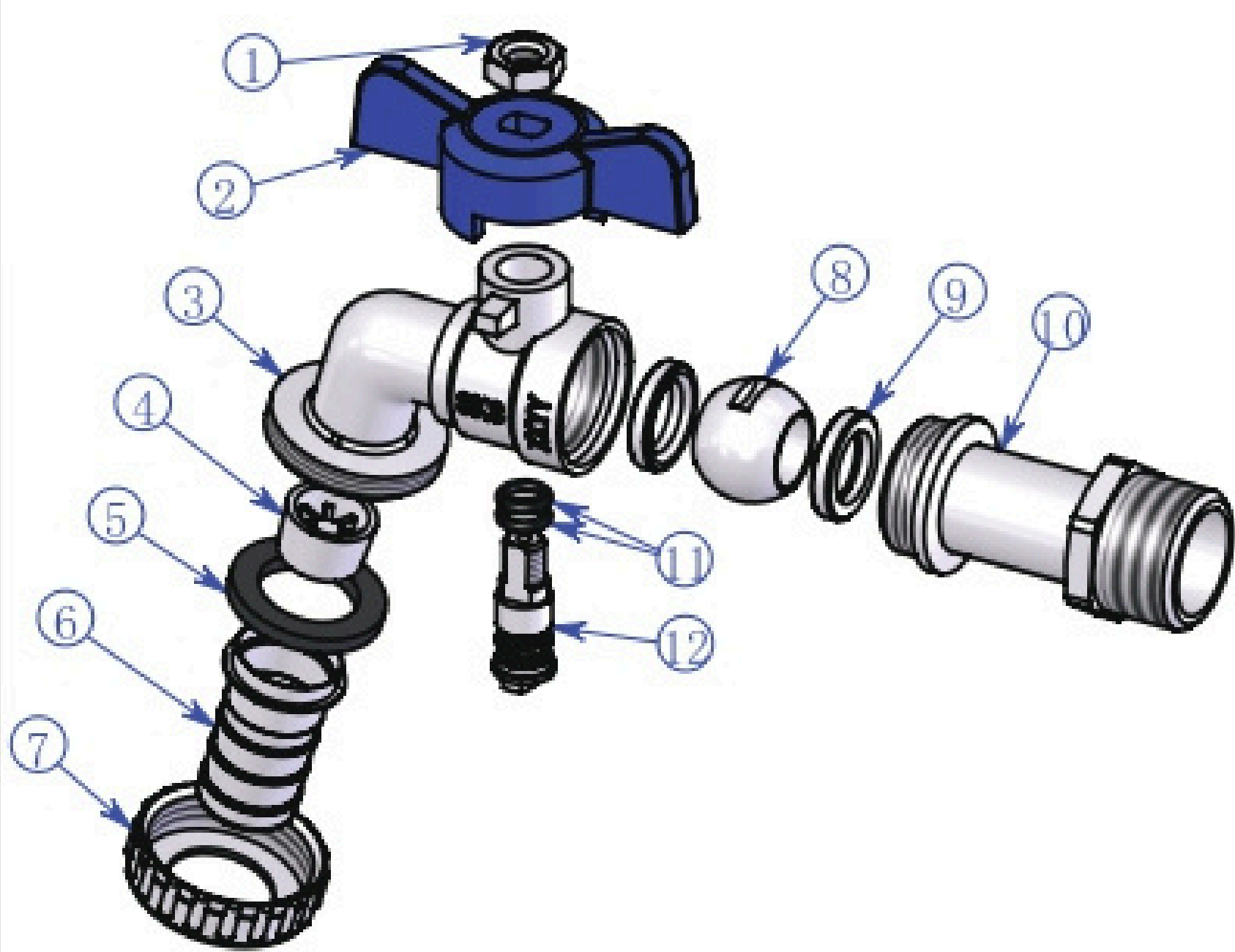
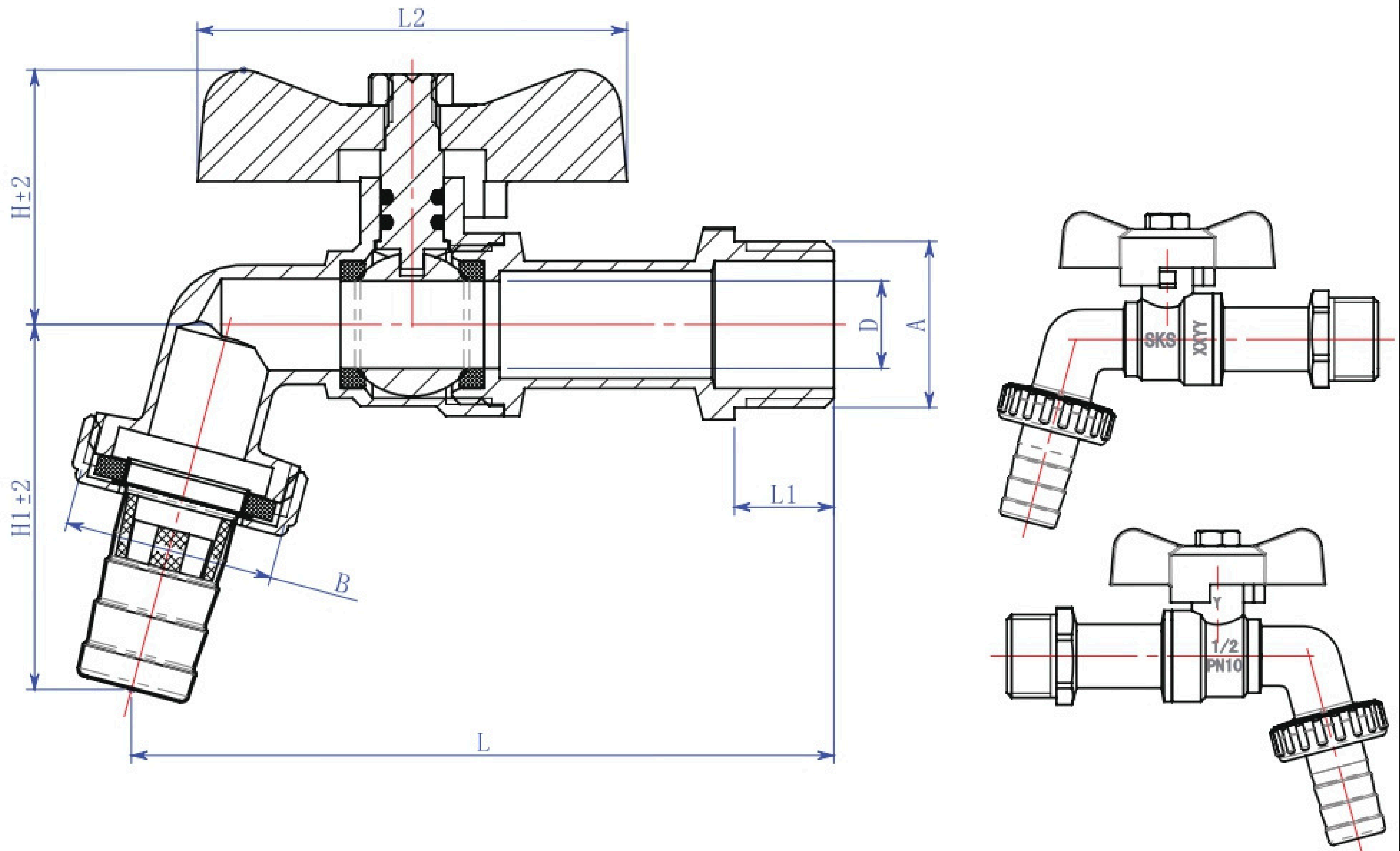

No.	Name	Material	QTY.
1	Hex-nut	Steel with Dacromet plated	1
2	T-handle	Aluminium alloy(RAL5012)	1
3	Body	Brass(Cu > 57% , Pb < 3%,Fe < 0.8%) with Nickel aplated	1
4	Manifold	PE	1
5	Washer	NBR	1
6	Outlet	Brass(Cu > 60.5%,Pb < 0.08%,Fe < 0.15%) with Nickel plated	1
7	Outlet nut	Brass(Cu > 57% , Pb < 3%,Fe < 0.8%) with Nickel plated	1
8	Ball	Brass(Cu > 55% , Pb < 4.5%,Fe < 1%) with Chrome plated	1
9	Seat ring	PTFE	2
10	Take-over	Brass(Cu > 57% , Pb < 3%,Fe < 0.8%) with Nickel aplated	1
11	O-ring	NBR	2
12	Stem	Brass(Cu > 55% , Pb < 4%,Fe < 1%) with Nickel plated	1

Specification:
 1. Working Pressure:1.0 MPa;
 2. Working temperature:-10°C~80°C;
 3. Surface:Nickel-plated.

EDITION

Customer drawing number

TOLERANCE OF DIMENSIONS AND GEOMETRY UNLESS OTHERWISE SPECIFIED				PRODUCT TYPE :		DWG.NO.		EDITION	
DIMENSION GB/T1804-m		ANGLE	PLUMB	2062		22062045001		A	
≤6	±0.1	±1°	±0.1	TITLE :		PROJECTION MEANS PRIMO ANGLE OF VIEW DRAWING UNIT mm		SCALE	
> 6≤30	±0.2								
> 30≤120	±0.3								
> 120≤400	±0.5								
DESIGN		Radman	2013. 07. 31	ART.		DESIGN SIGN G.W N.W. SCALE S A B 1:2		PAGE OF	
CHECKED		XGW	2013. 07. 31						
PROCESSOR		LWF	2013. 07. 31						
STANDARDIZATION		YSY	2013. 07. 31						
APPROVED		YSY	2013. 07. 31	SKS.534					