

S No.	PART NAME	MATERIAL
1	BODY	D.I / M.S
2	SEAT RING	EPDM
3	DISC	MS
4	FLANGE RING	EPDM
5	HOOK	MS

HYDROSTATIC TEST PRESSURE	
BODY (Kg/cm ²)	SEAT (Kg/cm ²)
24	17.6

S No.	RATING	40	50	65	80	100	125	150	200	250	300
ØD	PN16	102	110	132	145	160	188	220	270	325	370
Ød	PN16	33	42	60	71	90	110	130	175	220	265
H	PN16	20	20	22	25	25	25	30	34	34	36

SKS
VALVES

CLIENT	
P.O./ENQ. NO.	
Model :	SKS315
GAD No. :	19BFDT0001-04
Face to Face :	
Valve Type :	
Operator:	SCALE N.T.S
	SHEET 1 OF 1

Due to Continuous Development we reserve the rights to change in dimensions & Design keeping standard specification same.

All Dimensions are in MM unless otherwise stated.

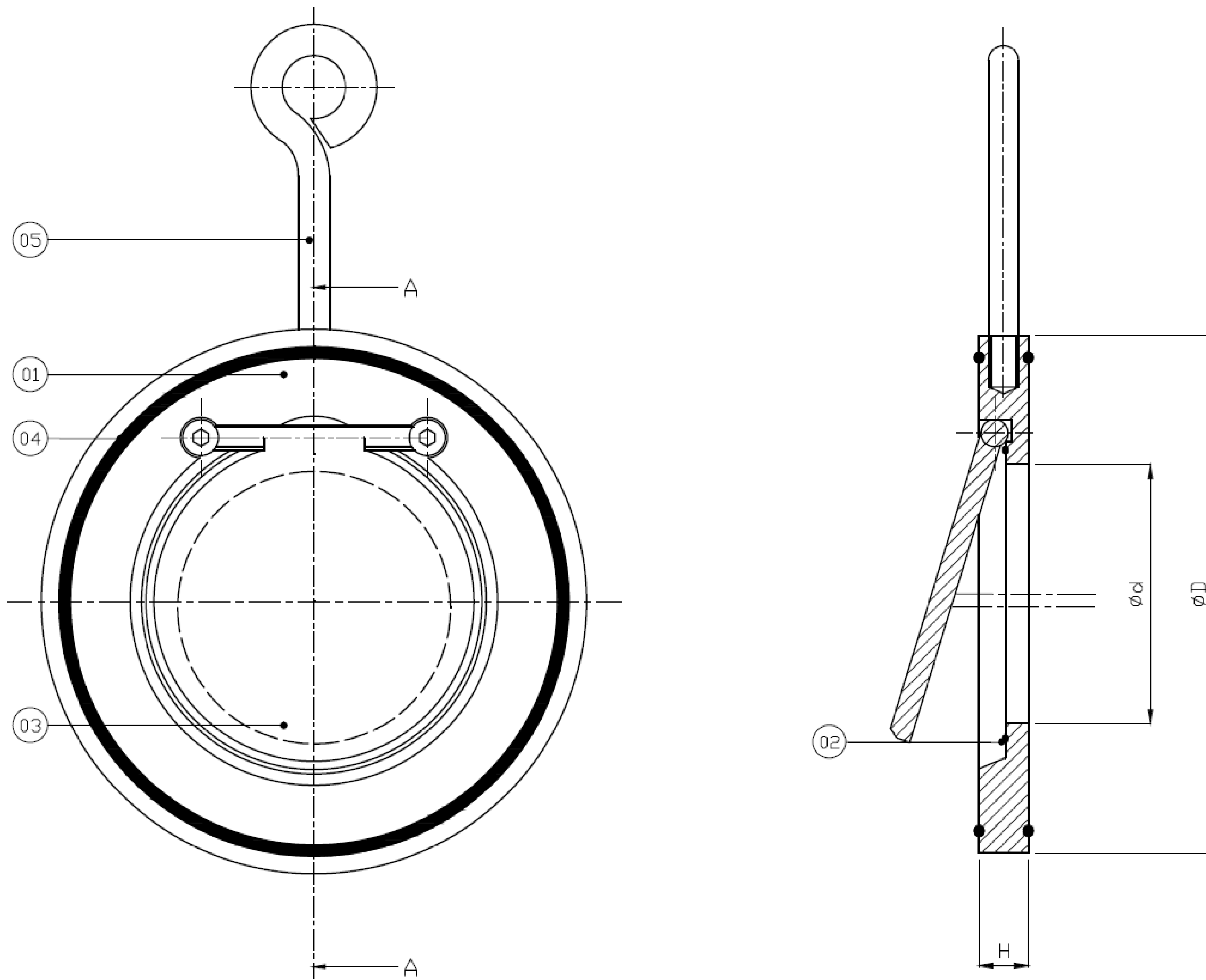

PT No.	PART NAME	MATERIAL
01	BODY	C.I / D.I / S.S / M.S
02	SEAT RING	EPDM
03	DISC	C.I / D.I / S.S / M.S
04	FLANGE RING	EPDM
05	HOOK	M.S / S.S
06	FASTNER	STAINLESS STEEL

SIZE	40	50	65	80	100	125	150	200	250	300
Ø D	102	110	132	145	160	188	220	270	325	370
Ø d	33	42	60	71	90	110	130	175	220	265
H	20	20	22	25	25	25	30	34	34	36

NOTE : FLANGE DRILLING IS AS PER BS10 TABLE

All Dimensions are in MM unless otherwise stated.

Due to Continuous Development we reserve the rights to change in dimensions & Design keeping standard specification same.

SKS
VALVES

CLIENT	
P.O./ENQ. NO.	
Model :	SKS 315
GAD No. :	
Face to Face :	
Valve Type :	
Operator:	
SCALE N.T.S	
SHEET 1 OF 1	